

DISTRICT	COUNTY	ROUTE	SECTION	SHEET
8-0	CUMBERLAND	1025	004	32 OF 42
EAST PENNSBORO TOWNSHIP				
REVISION NUMBER	REVISIONS	DATE	BY	

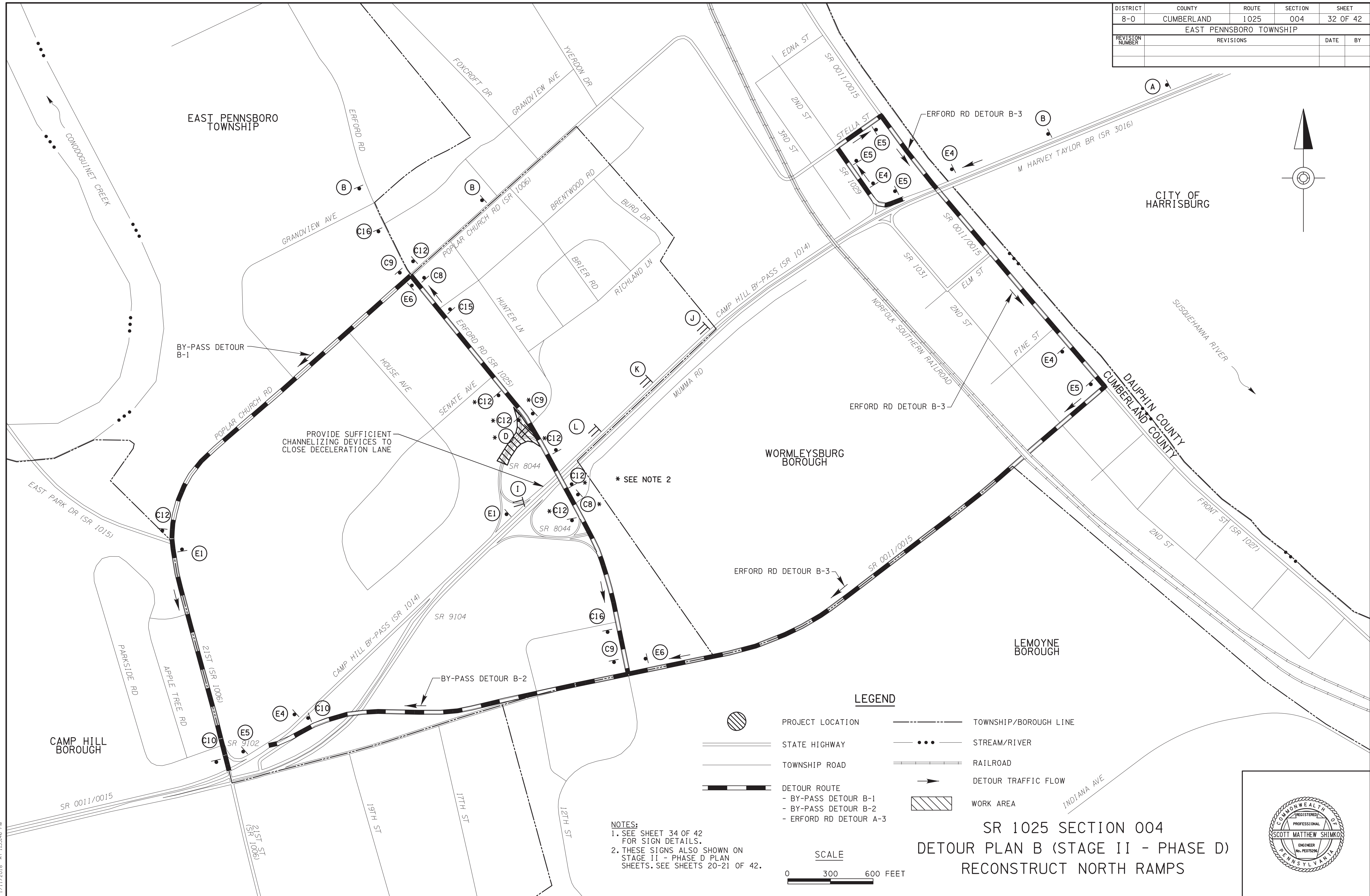
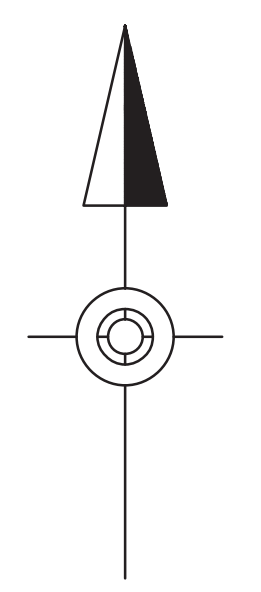

PROVIDE SUFFICIENT CHANNELIZING DEVICES TO CLOSE DECELERATION LANE

* SEE NOTE 2

LEGEND

- PROJECT LOCATION
- STATE HIGHWAY
- TOWNSHIP ROAD
- DETOUR ROUTE
 - BY-PASS DETOUR B-1
 - BY-PASS DETOUR B-2
 - ERFORD RD DETOUR A-3
- TOWNSHIP/BOROUGH LINE
- STREAM/RIVER
- RAILROAD
- DETOUR TRAFFIC FLOW
- WORK AREA

NOTES:
 1. SEE SHEET 34 OF 42 FOR SIGN DETAILS.
 2. THESE SIGNS ALSO SHOWN ON STAGE II - PHASE D PLAN SHEETS. SEE SHEETS 20-21 OF 42.

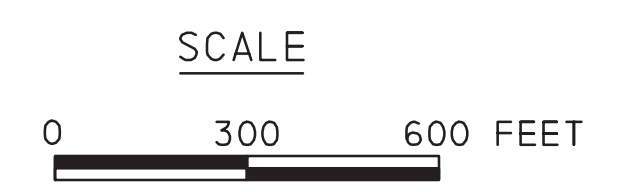

**SR 1025 SECTION 004
 DETOUR PLAN B (STAGE II - PHASE D)
 RECONSTRUCT NORTH RAMPS**

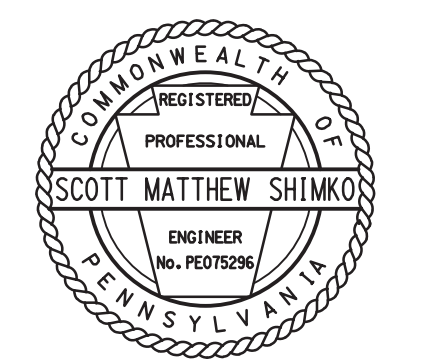

PA 20173071\005\CADD\Traffic Control Plan\102500_3071005.dgn
 1/11/2018 AT 1:53:46 PM